



THIRD FLOOR



| Room Name | Sq. Ft. | Length | Width | Ceiling Height | Classroom (3 per 6'') | Theater | Conference | Banquet | U-Shape | Reception | H-Square | Exhibit 8x10 | Exhibit 10x10 |
|----------------------|---------|--------|--------|----------------|-----------------------|---------|------------|---------|---------|-----------|----------|--------------|---------------|
| St. Charles Ballroom | 8,687 | 87.7' | 100.1' | 13' | 575 | 1,000 | - | 660 | - | 1,010 | - | 52 | 48 |
| St. James Ballroom | 5,618 | 56.8' | 99' | 12.3' | 330 | 700 | 90 | 450 | 100 | 646 | 115 | - | - |
| Jefferson Ballroom | 6,018 | 106.2' | 56.4' | 12.3' | 360 | 720 | 90 | 400 | 100 | 692 | 108 | 31 | 30 |
| Parish | 1,165 | 47' | 22.8' | 8.8' | 65 | 140 | 36 | 80 | 30 | 138 | 36 | - | - |
| The District Foyer | 6,547 | 60.3' | 97.8' | 11.3' | - | - | - | - | - | 650 | - | - | - |
| Fulton | 1,566 | 29' | 54.6' | 11' | 100 | 200 | 42 | 120 | 42 | 180 | 50 | - | - |
| Camp | 1,561 | 49.2' | 31.2' | 12' | 100 | 200 | 42 | 120 | 42 | 179 | 50 | - | - |
| Canal | 1,386 | 49.2' | 27.5' | 12' | 75 | 160 | 42 | 100 | 42 | 159 | 50 | - | - |
| Commerce | 1,458 | 49.2' | 29' | 12' | 85 | 180 | 42 | 110 | 42 | 168 | 50 | - | - |
| Royal | 1,471 | 49.6' | 29' | 12' | 100 | 200 | 42 | 120 | 42 | 177 | 50 | - | - |
| Magazine | 1,397 | 49.6' | 27.5' | 12' | 85 | 170 | 42 | 110 | 42 | 164 | 50 | - | - |
| Jackson | 1,648 | 55' | 29.4' | 12' | 110 | 220 | 48 | 130 | 45 | 189 | 54 | - | - |
| Trafalgar | 461 | 16.2' | 26.5' | 8.4' | 21 | 45 | 18 | 30 | 15 | 51 | 18 | - | - |
| Norwich | 461 | 16.2' | 26.5' | 8.4' | 21 | 45 | 18 | 30 | 15 | 51 | 18 | - | - |
| Durham | 461 | 16.2' | 26.5' | 8.4' | 21 | 45 | 18 | 30 | 15 | 51 | 18 | - | - |
| Warwick | 303 | 16.3' | 18' | 8.4' | 12 | 25 | 12 | 20 | 10 | 31 | 12 | - | - |
| Ascot/Newberry | 1,248 | 22.3' | 47.9' | 8.4' | 60 | 130 | 36 | 80 | 40 | 143 | 40 | - | - |
| Ascot | 608 | 22.3' | 21.3' | 8.4' | 24 | 60 | 18 | 40 | 18 | 70 | 18 | - | - |
| Newberry | 640 | 22.3' | 26.6' | 8.4' | 30 | 60 | 20 | 40 | 20 | 74 | 20 | - | - |
| Windsor | 1,215 | 56.2' | 22.1' | 8.4' | 50 | 100 | 30 | 80 | 20 | 140 | 20 | - | - |
| Breezeway | 2,748 | 29.8' | 92.2' | 11' | - | - | - | - | - | 300 | - | - | - |
| Bourbon Boardroom | 358 | 28.1' | 12.8' | - | - | - | 14 | - | - | - | - | - | - |

MISSISSIPPI RIVER

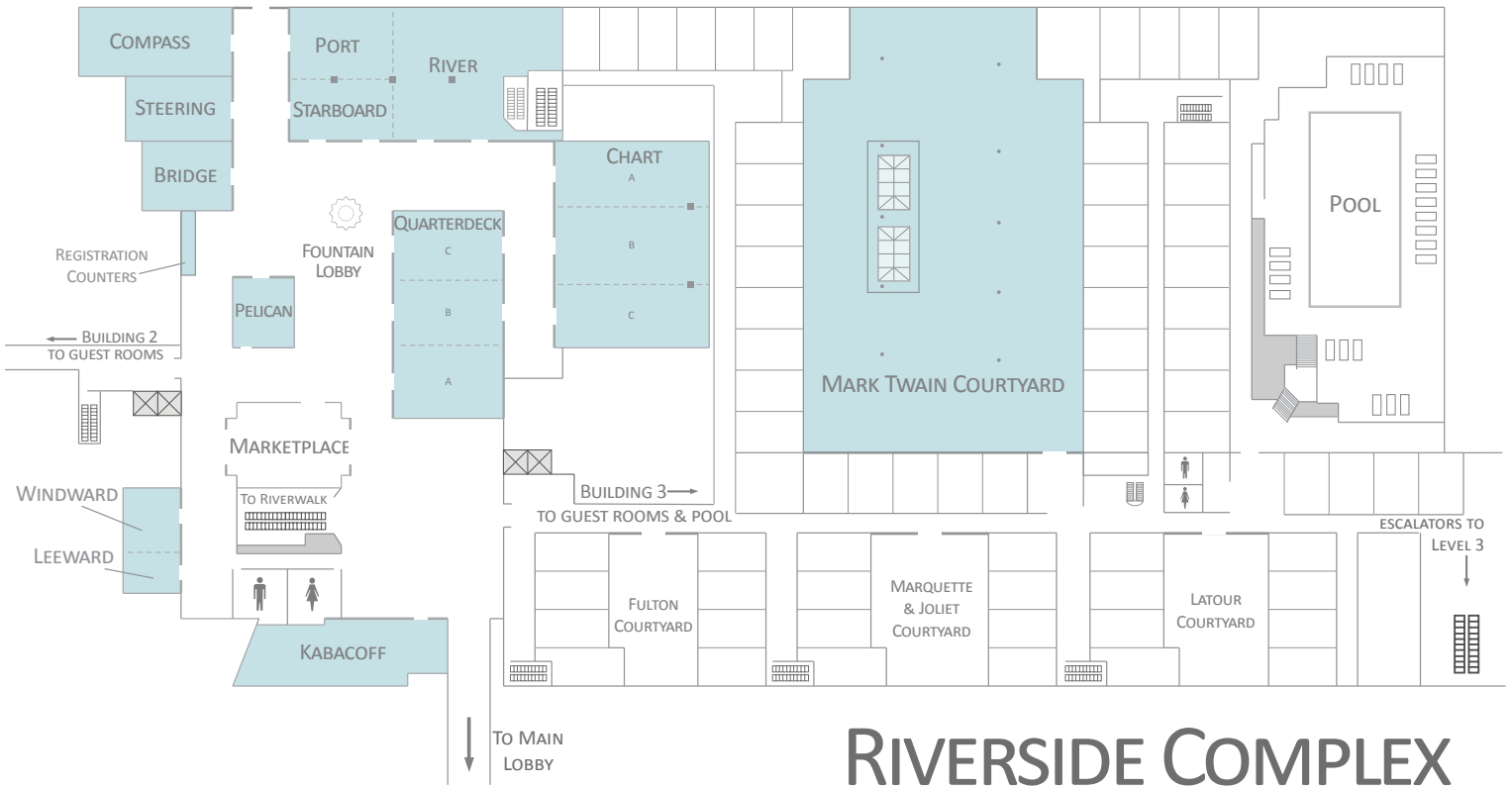

RIVERSIDE COMPLEX



| Room Name | Sq. Ft. | Length | Width | Ceiling Height | Classroom (3 per 6") | Theater | Conference | Banquet | U-Shape | Reception | H-Square |
|----------------------|---------|------------|-------------|----------------|-------------------------|---------|------------|---------|---------|-----------|----------|
| Pelican | 496 | 26' | 19.6' | 12.4' | 24 | 50 | 18 | 30 | 18 | 50 | 18 |
| Bridge | 809 | 33.5' | 24.3' | 12.3' | 45 | 85 | 24 | 60 | 24 | 90 | 30 |
| Steering | 933 | 38.6' | 24.5' | 12.3' | 45 | 100 | 30 | 60 | 30 | 100 | 36 |
| Compass | 1,438 | 57.8' | 24.6' | 12.3' | 90 | 175 | 42 | 100 | 42 | 150 | 48 |
| Port and Starboard | 1,911 | 49.2' | 39.5' | 12.3' | 95 | 212 | 44 | 100 | 34 | 200 | 38 |
| Port | 1,033 | 26.8' | 39.5' | 12.3' | 60 | 111 | 26 | 80 | 34 | 120 | 38 |
| Starboard | 878 | 22.3' | 39.5' | 12.3' | 51 | 93 | 36 | 70 | 34 | 80 | 32 |
| Kabacoff | 1,626 | 22' | 73.5' | 10.8' | 95 | 185 | 60 | 110 | 48 | 180 | 60 |
| River | 2,450 | 50'/ 23.8' | 58.7'/ 39.8 | 12.3' | 110 | 256 | 40 | 150 | 40 | 200 | 48 |
| Leeward and Windward | 773 | 19' | 39.7' | 10' | 42 | 90 | 30 | 50 | 27 | 75 | 30 |
| Leeward | 339 | 19' | 18.3' | 10' | 18 | 25 | 12 | 20 | 10 | 35 | 12 |
| Windward | 434 | 20.4' | 21.5' | 10' | 24 | 40 | 12 | 30 | 12 | 40 | 12 |
| Quarterdeck | 2,987 | 39.5' | 73.2' | 12' | 180 | 375 | 60 | 180 | 55 | 300 | 75 |
| Quarterdeck A | 940 | 39.5' | 21.5' | 12' | 45 | 100 | 30 | 60 | 30 | 100 | 30 |
| Quarterdeck B | 1,179 | 39.5' | 30.2' | 12' | 75 | 150 | 30 | 60 | 30 | 150 | 35 |
| Quarterdeck C | 868 | 39.5' | 21.6' | 12' | 45 | 100 | 30 | 60 | 30 | 100 | 30 |
| Chart | 3,882 | 52.8' | 72.3' | 10' | 175 | 430 | 60 | 240 | 65 | 400 | 75 |
| Chart A | 1,212 | 52.8' | 22.2' | 10' | 50 | 155 | 46 | 80 | 44 | 130 | 40 |
| Chart B | 1,472 | 52.8' | 27.8' | 10' | 75 | 185 | 46 | 80 | 44 | 150 | 40 |
| Chart C | 1,197 | 52.8' | 22.3' | 10' | 50 | 155 | 46 | 80 | 44 | 130 | 40 |
| Mark Twain Courtyard | 11,490 | 156' | 88' | - | - | - | - | 300 | - | 750 | - |