

# CAPACITY CHART FOR CONFERENCE & EVENT ROOMS

## CAPACITIES & DIMENSIONS

NAME OF ROOM	Total Square Footage	Reception	Banquet	Dinner/Dance	Classroom	Theater	Conference	U-Shape
Grand Orrington Ballroom	5848	550	450	270	360	550	N/A	N/A
Grand Parlour A	1280	100	90	N/A	72	117	26	30
Grand Parlour B	1544	160	120	N/A	100	160	40	33
Grand Parlour C	1534	125	100	N/A	84	128	32	36
Grand Parlour D	1790	X	X	N/A	N/A	N/A	N/A	N/A
Heritage Ballroom	1695	200	150	85	110	200	40	48
Lake Michigan Room	1026	70	60	N/A	N/A	N/A	N/A	N/A
North Shore Room	846	75	70	N/A	46	80	34	35
Mulford Room	570	30	40	N/A	28	47	20	23
Evans Room	570	30	40	N/A	28	47	20	23
Lunt Boardroom	285	N/A	N/A	N/A	N/A	N/A	10	N/A

## SECOND FLOOR



# CAPACITY CHART FOR CONFERENCE & EVENT ROOMS

## CAPACITIES & DIMENSIONS

CONFERENCE CENTER NAME OF ROOM	Dimensions L x W	Total Square Footage	Ceiling Height	Classroom	Theater	Conference	U-Shape
Hinman Auditorium	36'-6" X 36'-6"	1245	varies	76	N/A	N/A	N/A
Noyes Room	14'-6" X 15'-6"	220	12'-6"	8	18	6	9
Foster Room	14'-6" X 15'-6"	220	12'-6"	8	18	6	9
Wheeler Room	14' X 13'-6"	210	12'-6"	8	18	12	9
Haven Room	29' X 18'	525	12'-6"	23	32	14	16
Fowler Board Room	15' X 20'	300	12'-6"	N/A	N/A	10	N/A
Marcy Board Room	14' X 20'	270	12'-6"	N/A	N/A	10	N/A
Cummings Room	29' X 23'	645	12'-6"	36	48	18	20
Rogers Room	25' X 35'	890	12'-6"	50	88	26	28
Bonbright Room	29' X 35'	1005	12'-6"	55	88	26	29
James Room	31' X 35'	1075	12'-6"	60	72	32	28
Holgate Room	23' X 24'	560	12'-6"	23	43	14	15
Harris Boardroom	23' X 24'	500	12'-6"	N/A	N/A	10	N/A

## CONFERENCE CENTER 9TH FLOOR

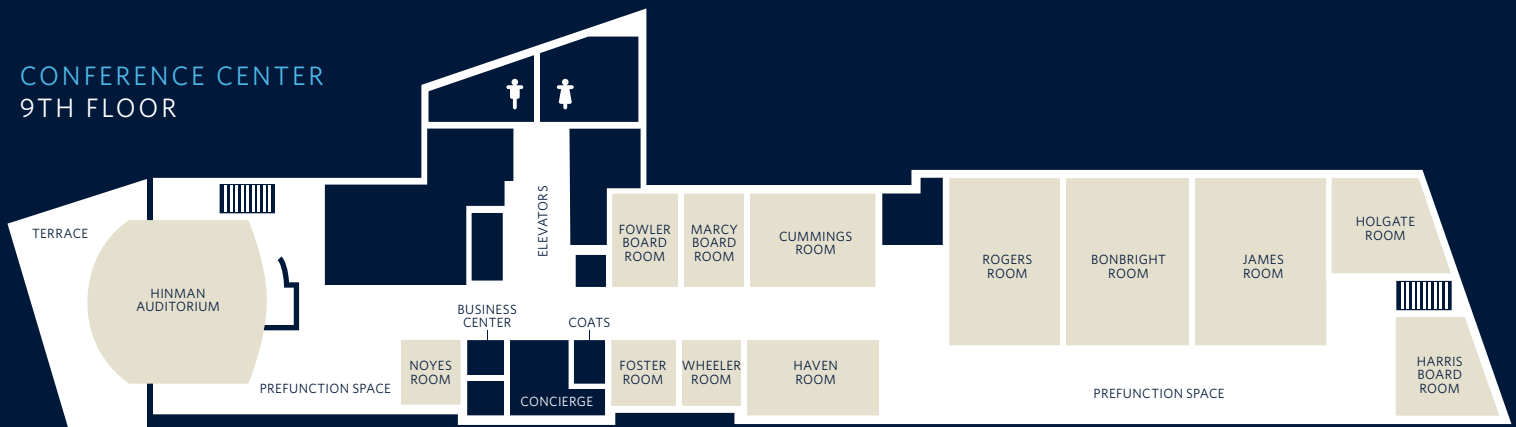

HILTON ORRINGTON/EVANSTON  
1710 Orrington Avenue | Evanston, IL 60201

T: +1 847 866 8700 | F: +1 847 866 8724  
E: [hiltonorrrington.info@hilton.com](mailto:hiltonorrrington.info@hilton.com)

[orrringtonevanston.hilton.com](http://orrringtonevanston.hilton.com)



AMERICAS • EUROPE • MIDDLE EAST • AFRICA • ASIA • AUSTRALASIA